

Scraper Block
minsup

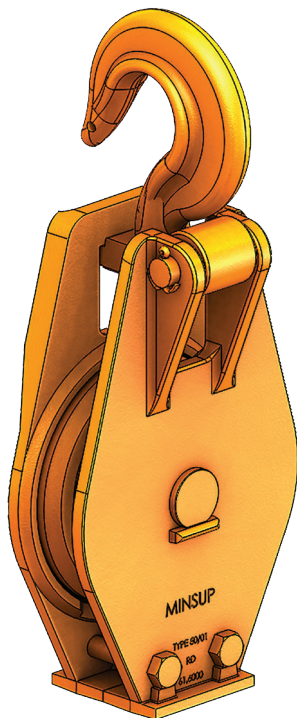

Minsup™ Scraper Blocks possess some very intelligent features, that's why you'll find Minsup™'s 2.037 tonne scraper blocks on oil fields and construction sites, lumber yards, inside industrial workshops and in underground mines.

The unit features shielded bearings to prohibit the entry of dirt and water. During assembly the bearings are packed in grease to last for life. The hook is forged from strong, dependable alloy steel (safe up to 2.037 tonne), side plates and the sheave wheels are cast in SG Iron. The block is suitable for either (1/2") 12.7 mm or (5/8") 15.9 mm SWR.

Features
<ul style="list-style-type: none"> • Side plates and sheave wheel are cast in SG iron • Hook is forged from alloy steel • M16 bolts are 8.8 high tensile • M16 Nyloc nuts are grade 8 • Bearing is shielded to prohibit the entry of dirt and water • Sealed bearing used to remove the need for maintenance • Hook swivels • Suitable for use on (1/2") 12.7mm or (5/8") 15.9mm steel wire rope • Safe working load 2 tonne (safety factor 5:1) • Assembly weight 20kgs

Feature: Unique design allows cable to be passed between latch plate and side plate eliminating reeving.

Part No.	Weight (kg)	Price \$ (ea)
08/050/01X/00	20	820.18

Price Group: SD
 AC04

P

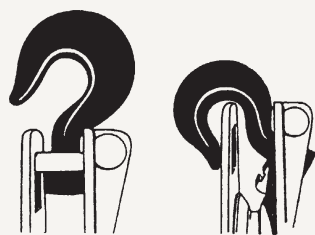

The Snatch Principle

Minsup™ 152mm (6") Block incorporates this very smart idea. Reeving is eliminated and first entry or removal of fixed end steel rope is made easy. Note too that the hook swivels.

Safety factor 5.