

## Clamp x Clamp Eccentric Reducers

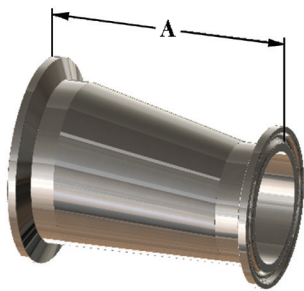

BPE Table #DT-21

Size (inch)	Dim (A)	PL Finish - SF1		PM Finish - SF4	
		Part No.	Price \$	Part No.	Price \$
¾ x ½	101.60	T3214MP075050PL	118.87	T3214MP075050PM	181.39
1 x ½	114.30	T3214MP100050PL	170.78	T3214MP100050PM	241.18
1 x ¾	101.60	T3214MP100075PL	118.16	T3214MP100075PM	188.56
1½ x ½	139.70	T3214MP150050PL	196.94	T3214MP150050PM	267.33
1½ x ¾	127.00	T3214MP150075PL	161.09	T3214MP150075PM	239.26
1½ x 1	127.00	T3214MP150100PL	123.01	T3214MP150100PM	201.18
2 x ½	196.85	T3214MP200050PL	270.46	T3214MP200050PM	360.35
2 x ¾	184.15	T3214MP200075PL	255.82	T3214MP200075PM	345.71
2 x 1	184.15	T3214MP200100PL	204.62	T3214MP200100PM	294.50
2 x 1½	133.35	T3214MP200150PL	144.02	T3214MP200150PM	233.90
2½ x ½	247.65	T3214MP250050PL	414.48	T3214MP250050PM	523.96
2½ x ¾	234.95	T3214MP250075PL	398.42	T3214MP250075PM	507.90
2½ x 1	234.95	T3214MP250100PL	301.87	T3214MP250100PM	411.35
2½ x 1½	184.15	T3214MP250150PL	220.27	T3214MP250150PM	329.75
2½ x 2	139.70	T3214MP250200PL	181.59	T3214MP250200PM	291.07
3 x 1	285.75	T3214MP300100PL	396.30	T3214MP300100PM	517.50
3 x 1½	234.95	T3214MP300150PL	329.04	T3214MP300150PM	450.23
3 x 2	190.50	T3214MP300200PL	249.56	T3214MP300200PM	370.75
3 x 2½	139.70	T3214MP300250PL	222.79	T3214MP300250PM	343.99
4 x 1	393.70	T3214MP400100PL	616.67	T3214MP400100PM	757.46
4 x 1½	342.90	T3214MP400150PL	562.24	T3214MP400150PM	703.02
4 x 2	298.45	T3214MP400200PL	461.85	T3214MP400200PM	602.64
4 x 2½	247.65	T3214MP400250PL	406.10	T3214MP400250PM	546.89
4 x 3	196.85	T3214MP400300PL	329.04	T3214MP400300PM	469.83
6 x 3	190.50	T3214MP600300PL	1266.47	T3214MP600300PM	1533.91
6 x 4	254.00	T3214MP600400PL	1284.05	T3214MP600400PM	1551.48

Price Group: DS  
AV14

J

## Solid End Caps

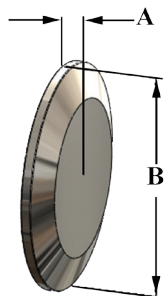

Size (inch)	Dim (A)	Dim (B)	PL Finish - SF1		PM Finish - SF4	
			Part No.	Price \$	Part No.	Price \$
½-¾	4.826	25.400	T16AMP-050075PL	13.02	T16AMP-050075PM	13.25
1-1½	6.350	50.546	T16AMP-100150PL	20.29	T16AMP-100150PM	21.45
2	6.350	64.008	T16AMP-200PL	33.03	T16AMP-200PM	34.87
2½	6.350	77.470	T16AMP-250PL	48.54	T16AMP-250PM	51.32
3	6.350	90.932	T16AMP-300PL	71.22	T16AMP-300PM	73.87
4	7.874	119.126	T16AMP-400PL	133.93	T16AMP-400PM	141.65
6	11.176	166.624	T16AMP-600PL	384.39	T16AMP-600PM	554.25

BPE Table #DT-31

Price Group: DS  
AV14

## Auto Weld Ferrules

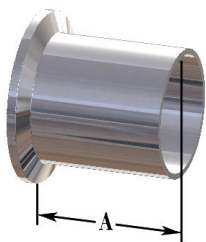

BPE Table #DT-22

Size (inch)	Dim (A)	PL Finish - SF1		PM Finish - SF4	
		Part No.	Price \$	Part No.	Price \$
½	44.45	TL14AM7-050PL	32.11	TL14AM7-050PM	81.56
¾	44.45	TL14AM7-075PL	34.29	TL14AM7-075PM	74.61
1	44.45	TL14AM7-100PL	43.13	TL14AM7-100PM	96.78
1½	44.45	TL14AM7-150PL	39.84	TL14AM7-150PM	82.66
2	57.15	TL14AM7-200PL	52.89	TL14AM7-200PM	123.40
2½	57.15	TL14AM7-250PL	70.36	TL14AM7-250PM	194.24
3	57.15	TL14AM7-300PL	92.35	TL14AM7-300PM	207.95
4	57.15	TL14AM7-400PL	141.60	TL14AM7-400PM	311.27
6	76.20	TL14AM7-600PL	756.38	TL14AM7-600PM	717.07

Price Group: DS  
AV14

Note: Not all sizes and finishes are stocked.

PL Finish - SF1

OD = 32R<sub>a</sub> Mechanically Polished

ID = 20R<sub>a</sub> Mechanically Polished

PM Finish - SF4

OD = 32R<sub>a</sub> Mechanically Polished

ID = 15R<sub>a</sub> Mechanically Polished & Electropolished