

V-Series Snap-Tite H/H Interchange Valved Couplers - JIC

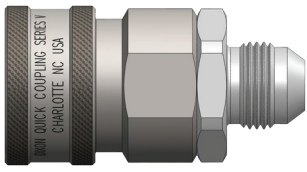

JIC Male Thread

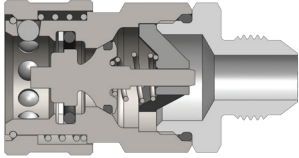

Size (inch)	Part No.	Thread Size (inch)	Body Material	Weight (kg)	Pkg Qty		Price \$ (ea)
					Bag	Box	
¼	2VJM2	7/16 - 20 JIC	Steel	0.11	5	50	126.90
3/8	3VJM3	9/16 - 18 JIC	Steel	0.14	5	50	70.27
½	4VJM4	¾ - 16 JIC	Steel	0.23	5	25	66.41
¾	6VJM6	1 1/16 - 12 JIC	Steel	0.45	5	20	101.43
1	8VJM8	1 5/16 - 12 JIC	Steel	0.67	-	10	178.46

Price Group: PC
AP11

V-Series Snap-Tite H/H Interchange Valved Nipples - JIC

G

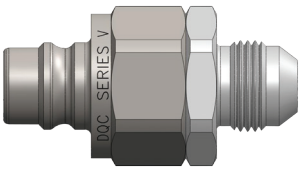

JIC Male Thread

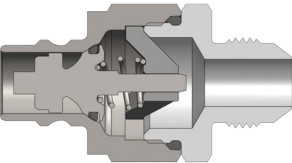

Size (inch)	Part No.	Thread Size (inch)	Body Material	Weight (kg)	Pkg Qty		Price \$ (ea)
					Bag	Box	
3/8	V3JM3	9/16 - 18 JIC	Steel	0.11	5	50	44.18
½	V4JM4	¾ - 16 JIC	Steel	0.17	5	25	56.74
¾	V6JM6	1 1/16 - 12 JIC	Steel	0.32	5	20	95.90
1	V8JM8	1 5/16 - 12 JIC	Steel	0.61	-	10	146.79

Price Group: PC
AP11

FOR TECHNICAL GUIDELINES PLEASE REFER TO PAGE 322

