

'A' Type - Standard Seal 500 PSI - SG Iron



Features:	Standard coupling heads ensure the interchangeability of all sizes, regardless of whether the mating coupling is male, female or hose tail.
Options:	Other seal materials available on request NPT threads available for Male and Female threaded couplings

Size (inch)	Pkg Qty	Male BSP		Male NPT	
		Part No.	Price \$ (ea)	Part No.	Price \$ (ea)
3/8	50	08/001/12/000	17.09	08/001/12/004	22.73
1/2	50	08/001/09/000	13.38	08/001/09/004	22.73
3/4	50	08/001/06/000	13.38	08/001/06/004	22.73
1	50	08/001/03/000	13.38	08/001/03/004	22.73
1 1/4	40	08/001/01/000	18.62	---	---

Price Group: MS
AA01



Size (inch)	Pkg Qty	Female BSP		Female NPT	
		Part No.	Price \$ (ea)	Part No.	Price \$ (ea)
3/8	50	08/001/13/000	17.09	08/001/13/004	22.73
1/2	50	08/001/10/000	13.38	08/001/10/004	22.73
3/4	50	08/001/07/000	13.38	08/001/07/004	22.73
1	50	08/001/04/000	13.38	08/001/04/004	22.73

Price Group: MS
AA01

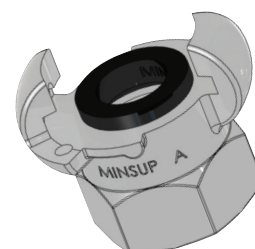

Size (inch)	Pkg Qty	Hose End	
		Part No.	Price \$ (ea)
3/8	50	08/001/14/000	17.09
1/2	50	08/001/11/000	13.38
3/4	50	08/001/08/000	13.38
1	50	08/001/05/000	13.38
1 1/4	40	08/001/02/000	18.62

Price Group: MS
AA01



For Minsup™ Safety Claw Clamps, refer to page 126.

For ring crimp ferrules, refer to page 125.

Size (inch)	Pkg Qty	King Crimp Hose End	
		Part No.	Price \$ (ea)
1	50	AH25KC	16.22

Price Group: MS
AA01



Note: Designed for use with King Crimp™ ferrules.

- 'A' type bellow seal couplings are not recommended for use with Minsup™ standard seal couplings.
- **WARNING:** Never use 'A' Type Couplings for steam service! None of Dixon™'s catalogue information is to be interpreted to mean that this type of coupling is suitable for use on steam hose.

FOR SPECIFICATIONS, APPLICATION AND MATERIAL GUIDELINES PLEASE REFER TO PAGE 114



1300 134 651
dixonvalve.com.au

All prices exclude GST.
ADPL718