

High flow pilot regulator, 1-1/2" and 2"

Provides rapid response, superior pressure regulation, and excellent stability.

Constant bleed feature in pilot regulator provides quick response and maintains accurate downstream pressures

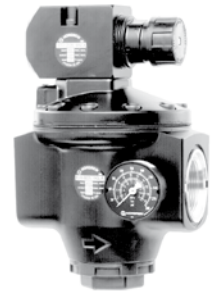

Technical data

Fluid:

Compressed air, neutral gases

NOTE: Contact technical support for use with other media.

Inlet pressure range:

10 psig (0.7 bar) minimum to 450 psig (31 bar) maximum

Operating temperature:

0°F to 175°F (-18° to 80°C)

* Air supply must be dry enough to avoid ice formation at temperatures below 35°F (2°C)

Materials

Body: aluminum

Bonnet: aluminum

Bottom plug: aluminum

Pilot Operated Regulator:

aluminum

Elastomers: nitrile

Ordering information

Models listed have PTF threads, knob adjustment, relieving type diaphragm, and gauge.

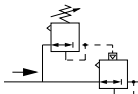
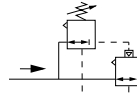
ISO Symbols	Port Size	Model Number	Flow† scfm (dm ³ /s)	Weight lbs (kg)	
 R18 with Conventional Pilot Regulator	 R18 with Feedback Pilot Regulator	2"	R18-C05-RGLA	2000 (944)	8.27 (3.75)

† Typical flow with 100 psig (0.7 bar) inlet pressure, 90 psig (6.3 bar) set pressure and a droop of 15 psig (1 bar) from set.

R18-★★★★-★★★★		Port Threads	Substitute
Port Size	Substitute	PTF	A
1-1/2"	B	ISO G	G
2"	C	Outlet Pressure Adjustment Ranges*	Substitute
Pilot Regulator Type	Substitute	5 to 50 psig (0.3 to 3.5 bar)	E
R40 Conventional	05	5 to 125 psig (0.3 to 8.5 bar)	L
R41 Feedback **	06	10 to 250 psig (0.7 to 17 bar)	S
Diaphragm	Substitute	Gauges	Substitute
Relieving	R	With	G
Non relieving	N	Without	N

* Outlet pressures can be adjusted to pressures in excess of, and less than, those specified. Do not use these units to control pressures outside of the specified ranges.

** Requires relieving diaphragm and 250 psig (17 bar) spring (R in 7th position and S in 9th position) e.g. R18-B06-RNSG. The 06 option cannot be used at an outlet pressure below 100 psig. For feedback control at pressures below 100 psig use an 11-104-001 with a pilot operated R18.

NOTE: The R18 can be used with other pilot regulators and proportional valves such as 11-400, 20-AL, 11-104, VP50 and VP51

Typical Performance Characteristics
R18

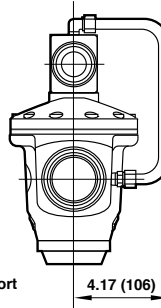
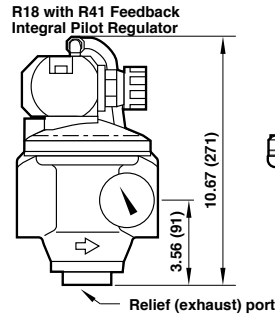
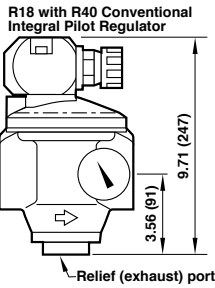
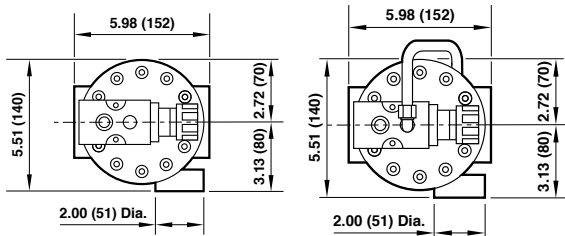
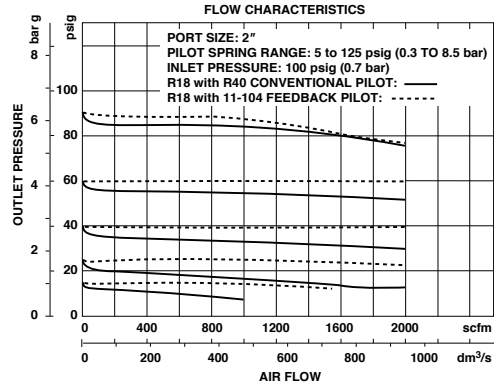

Dimensions in inches (mm)

Service Kits

Item	Type	Part number
Service kits	R18 Pilot operated regulator**	5945-40
	R40 and R41 Pilot regulators†	5945-41

** Contains filter screen and all o-rings for R18 pilot operated regulator.

† Contains diaphragm, valve spring, valve, guide bushing, filter screen, and all o-rings for R40 and R41 pilot regulators.